

REVISIONS		
DATE	SURVEYOR	N.J. LICENSE NO.
12/2002	LEWIS H. CONLEY JR.	21212
11/2005	LEWIS H. CONLEY JR.	21212

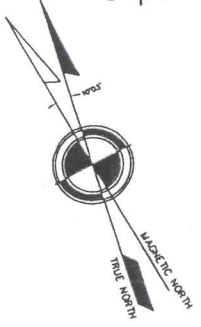

S.S. Atlantus
concrete ship

Beach Entrances:
 Stites South Lake Dr
 Brainard Coral *ADA ACCESS
 Pearl (Emerald) Whilldin
 Cape Lehigh



I HEREBY CERTIFY THAT THIS MAP AND THE SURVEY HAS BEEN MADE UNDER MY IMMEDIATE SUPERVISION AND COMPLIES WITH THE LAWS OF THE STATE OF NEW JERSEY.

LEWIS H. CONLEY JR.
 PROFESSIONAL LAND SURVEYOR
 NEW JERSEY LICENSE #21212

THIS TAX MAP SUPERSEDES THE TAX MAP APPROVED MAY 02, 1977

TO SHOW CONDITIONS AS OF FEBRUARY 2005

Note: the Lighthouse and State Park are located in the Township of Lower

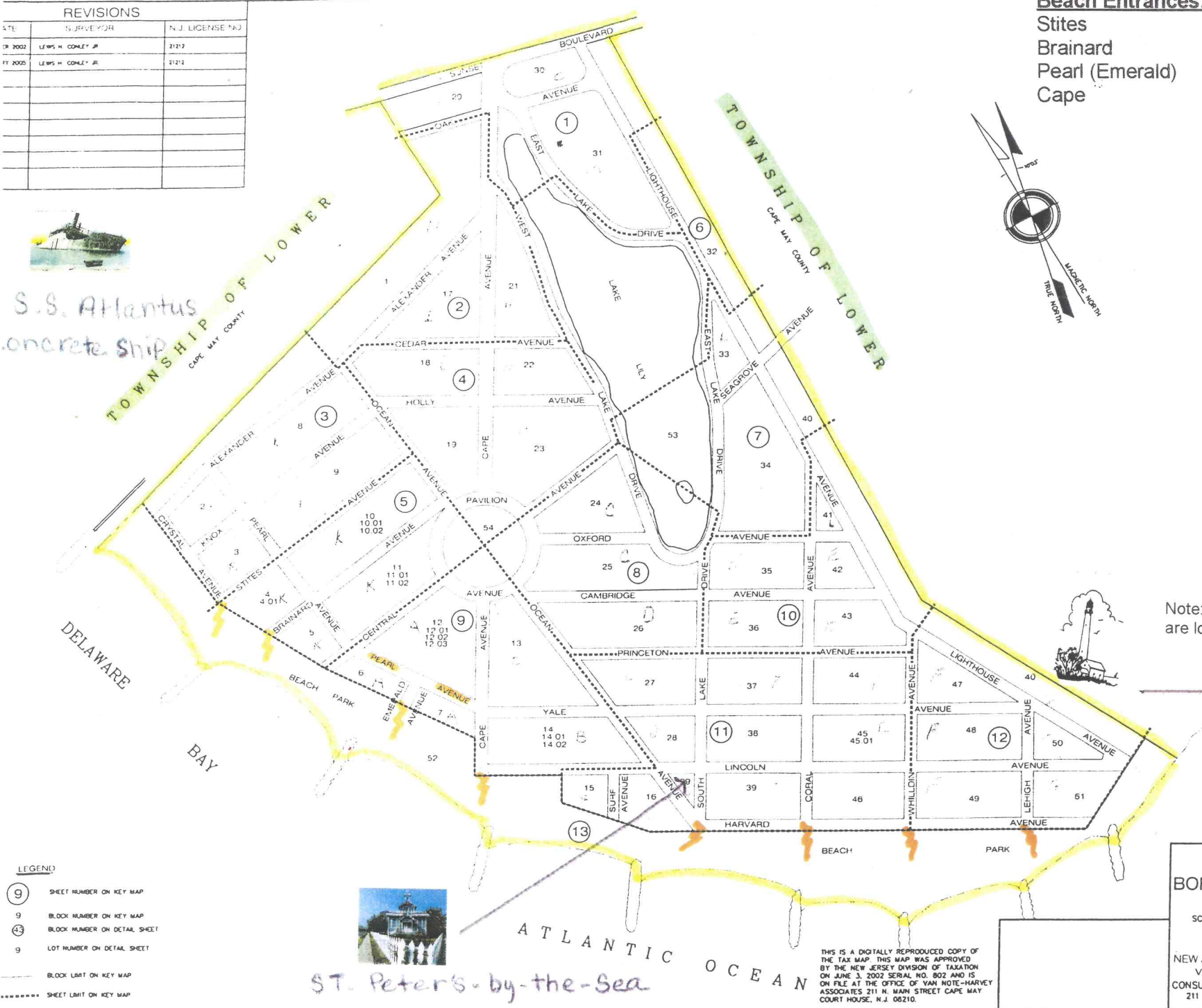

LEGEND

(9)	SHEET NUMBER ON KEY MAP
9	BLOCK NUMBER ON KEY MAP
43	BLOCK NUMBER ON DETAIL SHEET
9	LOT NUMBER ON DETAIL SHEET
---	BLOCK LIMIT ON KEY MAP
-----	SHEET LIMIT ON KEY MAP



ST. Peter's - by-the-Sea

THIS IS A DIGITALLY REPRODUCED COPY OF THE TAX MAP. THIS MAP WAS APPROVED BY THE NEW JERSEY DIVISION OF TAXATION ON JUNE 3, 2002 SERIAL NO. 802 AND IS ON FILE AT THE OFFICE OF VAN NOTE-HARVEY ASSOCIATES 211 N. MAIN STREET CAPE MAY COURT HOUSE, N.J. 08210.

KEY MAP
 BOROUGH OF CAPE MAY POINT
 CAPE MAY COUNTY, NEW JERSEY
 SCALE: 1" = 200' DATE: DECEMBER 2000
 LEWIS H. CONLEY JR.
 NEW JERSEY LICENSED LAND SURVEYOR NO. 212
 van note-harvey associates, p.c.
 CONSULTING ENGINEERS, PLANNERS, LAND SURVEYOR
 211 N. MAIN STREET CAPE MAY COURT HOUSE, N.J. 08210

KEY MAP